

ADDENDUM NO. 3

To the Plans and Specifications for:

FY25 Stormwater Improvements

City of Seminole

1. **BID DATE: NO CHANGE**

Friday, April 4, 2025 @ 11:00 A.M.

2. **TECHNICAL SPECIFICATIONS: NO CHANGE**

3. **PLANS:**

A. Sheet C8, Plan & Profile (Baywood Park Drive)

The location of the manhole structure has changed. The alignment of the sanitary sewer has been updated. A callout has been added regarding the buried electric line that crosses the street within the project area.

4. **RESPONSE TO SUBMITTED QUESTIONS: NO CHANGE**

5. **GENERAL CLARIFICATION / INFORMATION: NO CHANGE**

CITY OF SEMINOLE

March 31, 2025

NOTE:
CONFIRM PIPE SIZE PRIOR TO STRUCTURE FABRICATION

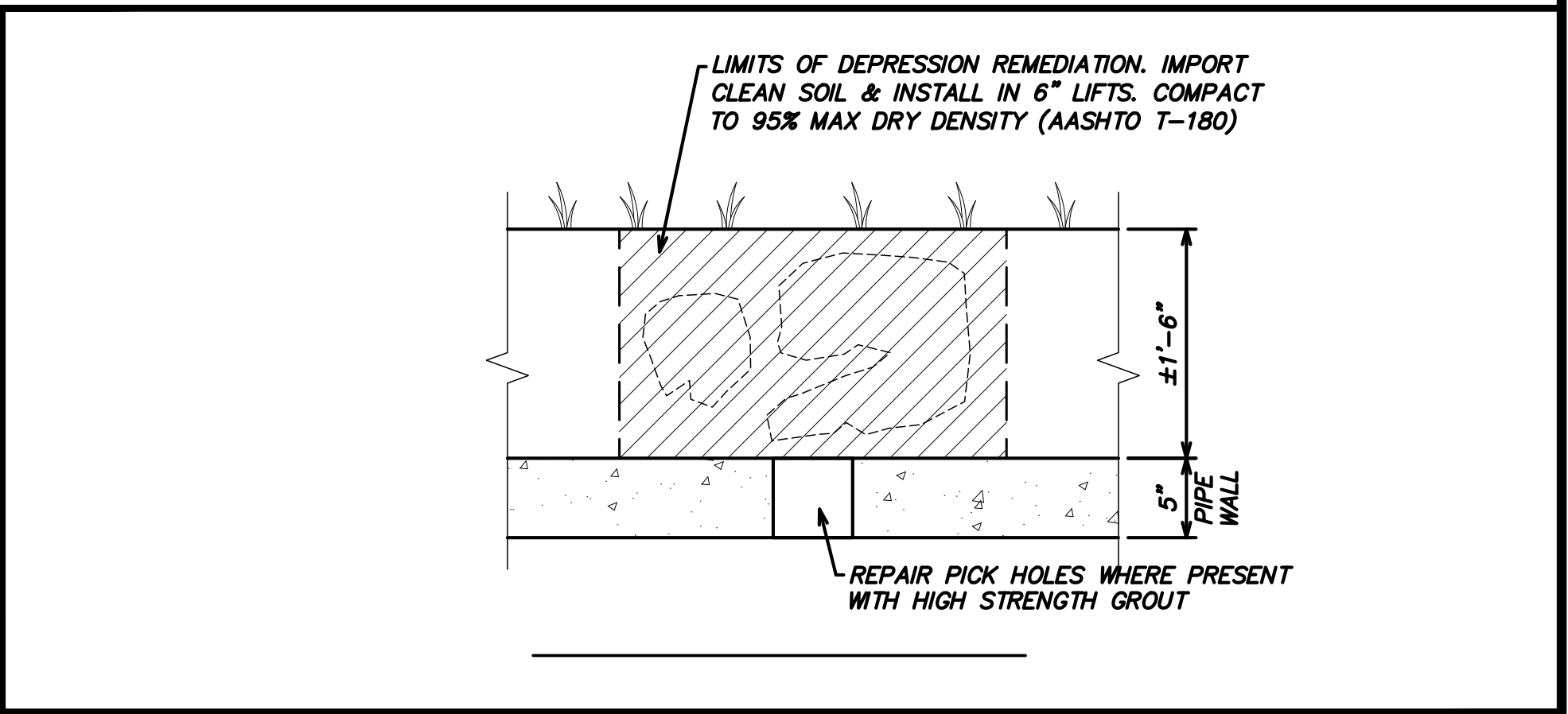
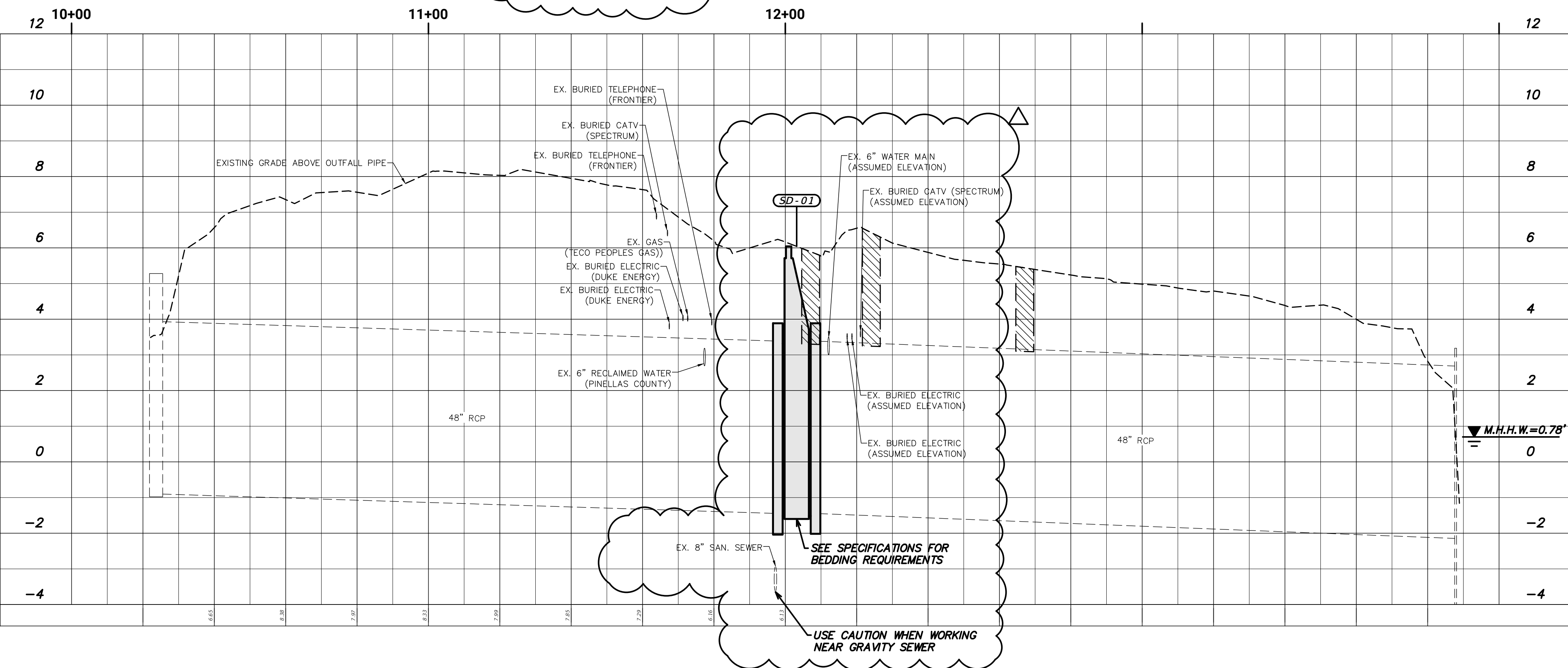
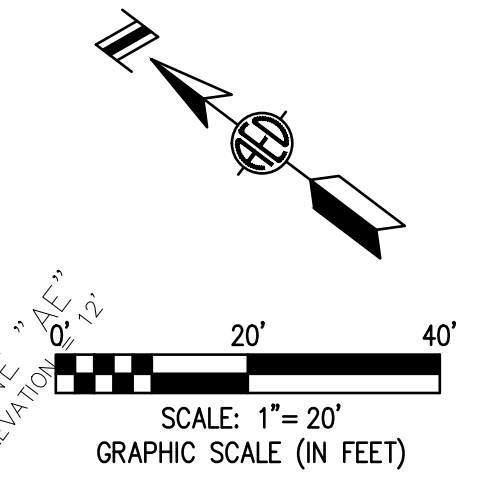
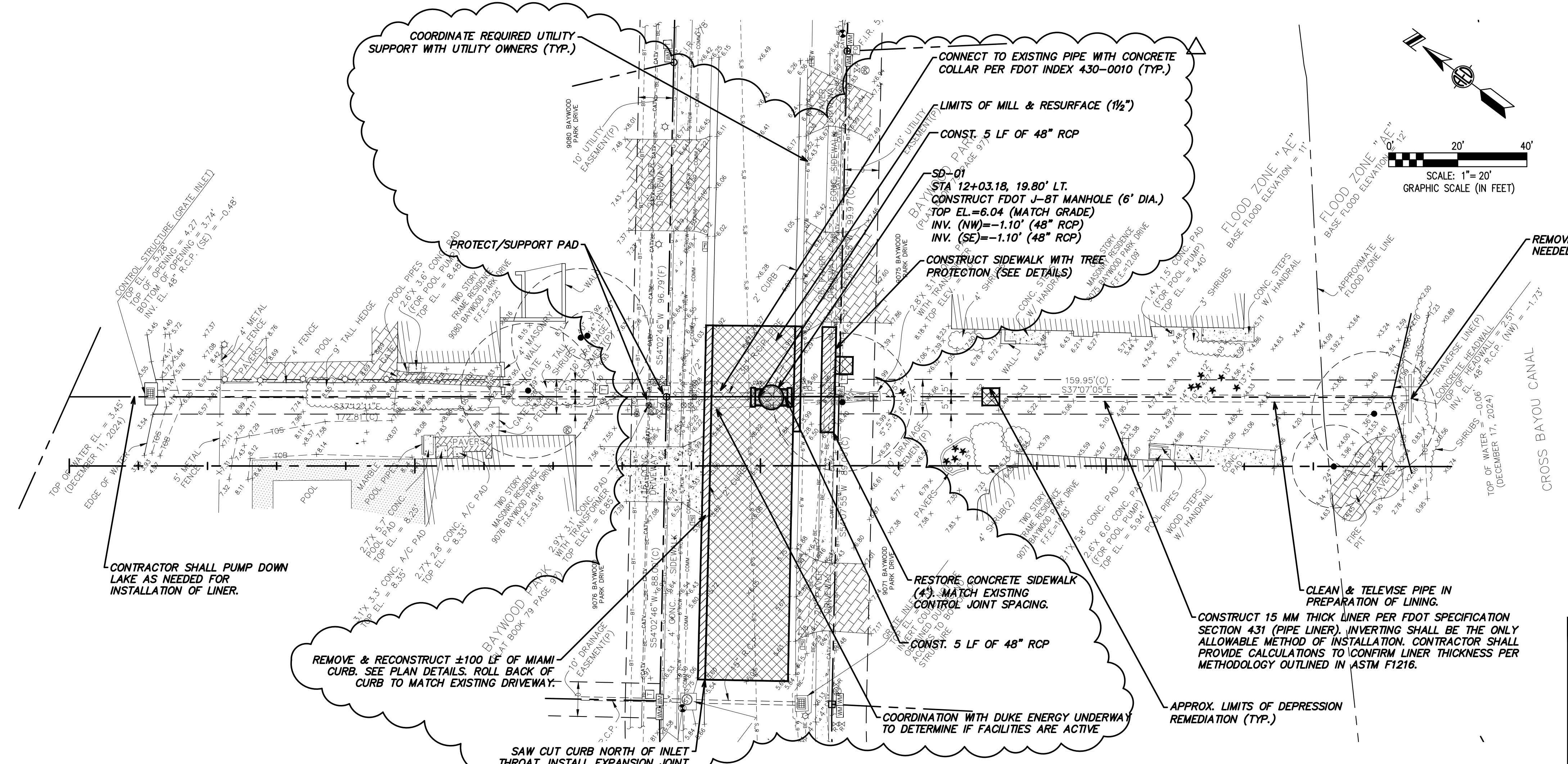

NOTE:
CITY WILL PERMIT FULL ROAD CLOSURE. PLACE DETOUR SIGNAGE AT NORTHERN INTERSECTION. MAINTAIN LOCAL TRAFFIC & DRIVEWAY ACCESS.

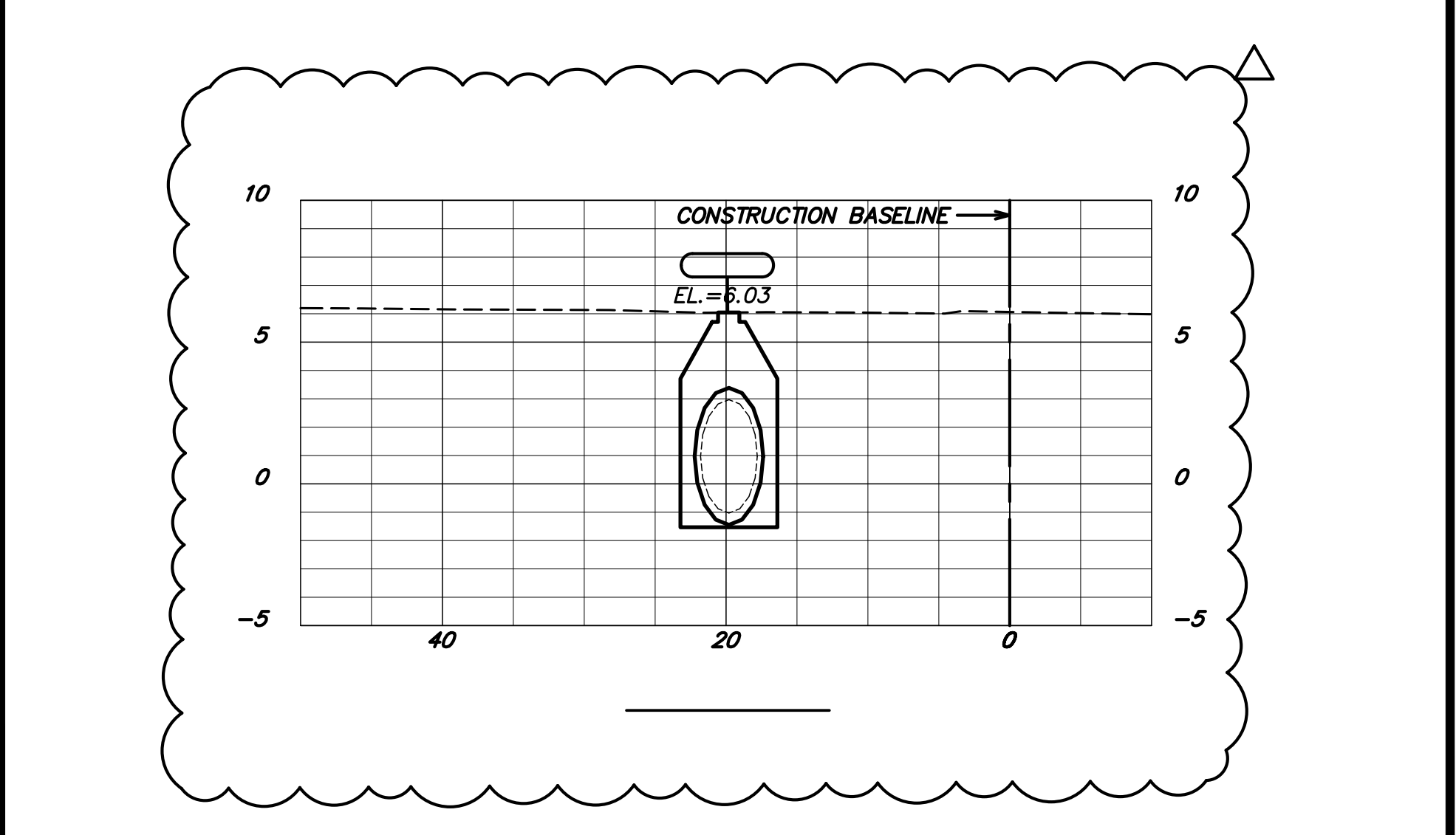

USER: [Steven.Torres] Date: [Mar 28, 2025] Time: [5:26pm] File Location: [M:\Public\Seminole\24.sem-36 (FY25 stormwater improvements)\Good\SEM-36_C6-P&P_Addendum2.dwg]

NO.	REVISIONS	BY	DATE
Δ	ADDENDUM NO 2	J.V.K.	3/28/2025

SCALE: 1"=20' (HORZ.)
SCALE: 1"=2' (VERT.)
DRAWN: S.A.T.
DESIGNED: A.E.D.
APPROVED: J.V.K.

ADVANCED
ENGINEERING & DESIGN, INC.
3931 68th Avenue North, Pinellas Park, FL 33781 • (727) 526-9158 • www.aed-fl.com



FY25 STORMWATER IMPROVEMENTS